



Leon Creek WRC Electrical System Improvements Phase I
Solicitation Number: CO-00335
Job No.: 19-6505

ADDENDUM 2
June 8, 2020

To Bidder of Record:

This addendum, applicable to work referenced above, is an amendment to the bid proposal, plans and specifications and as such will be a part of and included in the Contract Documents. Acknowledge receipt of this addendum by entering the Addendum number and issue date on the space provided in submitted copies of the bid proposal.

RESPONSES TO QUESTIONS

1. **N/A**
Response:

CHANGES TO THE SPECIFICATIONS

1. Supplemental Conditions, Page SS-1
 - a. Delete line item 24 (b)
 - b. Replace line item 24 (b) with the following: “(b) A detailed Baseline Schedule, using August 24, 2020 for the Notice To Proceed (NTP).”

CHANGES TO THE PLANS

1. Remove the following sheets and replace with the attached sheets:
 - a. 50C06
 - b. 60E02

CLARIFICATIONS

1. **N/A**

END OF ADDENDUM

This Addendum, including these two (2) pages, is four (4) pages with attachments in its entirety.
Attachments:

Drawings: 2 pages, 11x17 (HALF SIZE)



William D. Sako, P.E.
Gupta & Associates, Inc.
TBPE # F-2593

 6/8/2020

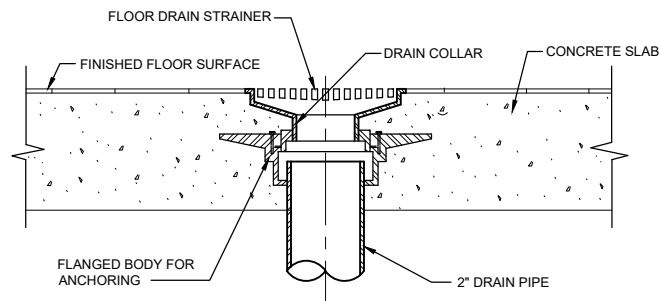

FLOOR DRAIN
DETAIL A
50C06

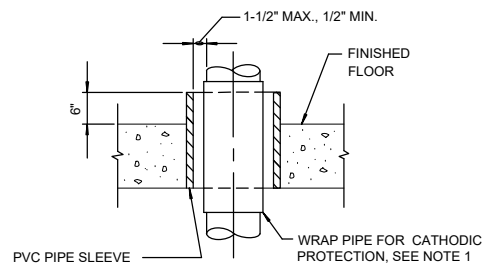

FLOOR PIPE PENETRATION
DETAIL B
50C06

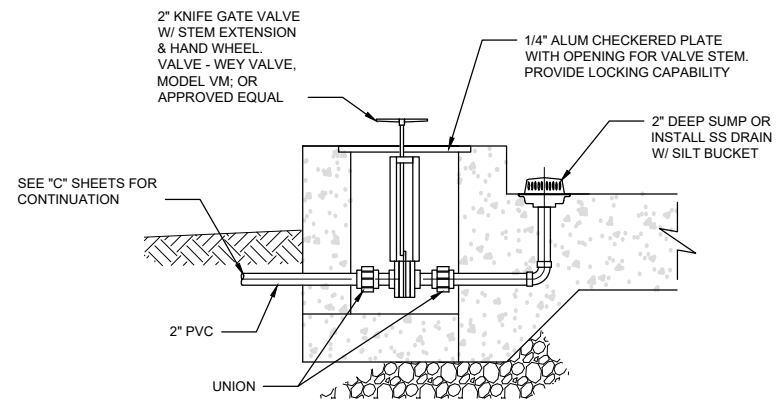

TRANSFORMER PAD DRAIN
DETAIL D
SCALE: 3/4" = 1'-0"
50C06

NOTES:
1. FOR COPPER PIPE CONDITION, PROVIDE A FULL 360 DEGREE WRAP OF 1/16 INCH THICK NEOPRENE. BOND NEOPRENE TO PIPE WITH A COMPATIBLE WATER PROOF ADHENSIVE. EXTEND NEOPRENE 1-INCH MINIMUM BEYOND LIMITS OF PENETRATION SLEEVE.

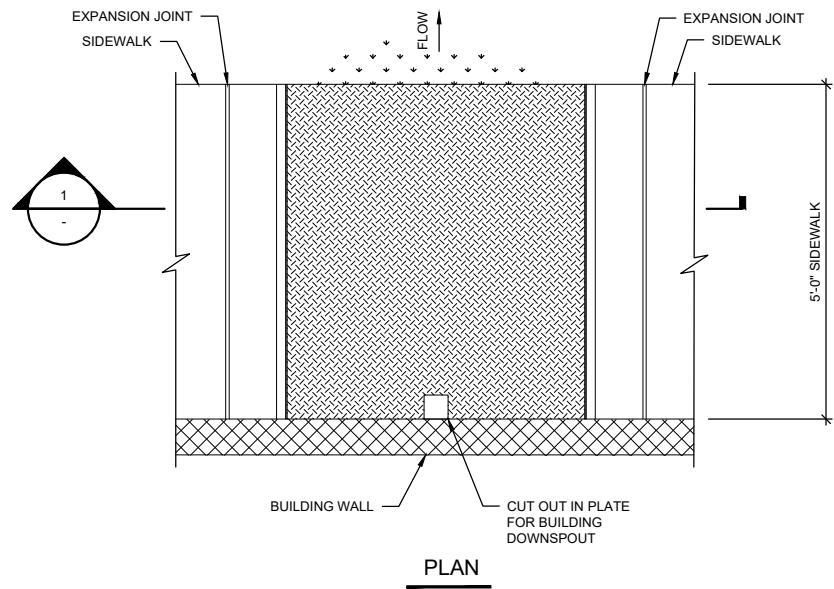

SIDEWALK DRAIN DETAIL
DETAIL C
50C06

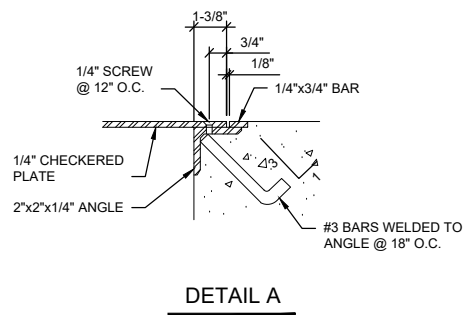

DETAIL A

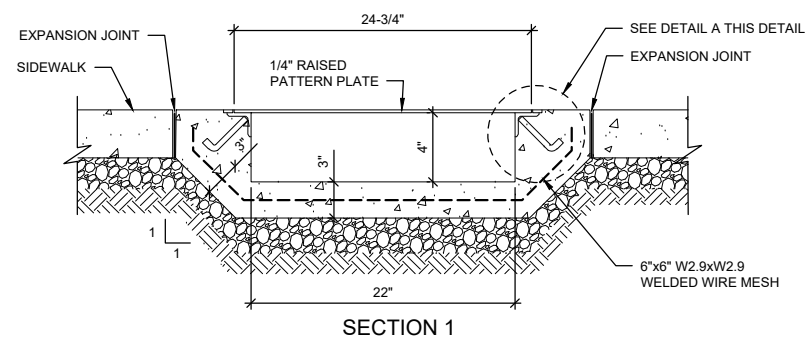

SIDEWALK DRAIN DETAIL
DETAIL C
50C06

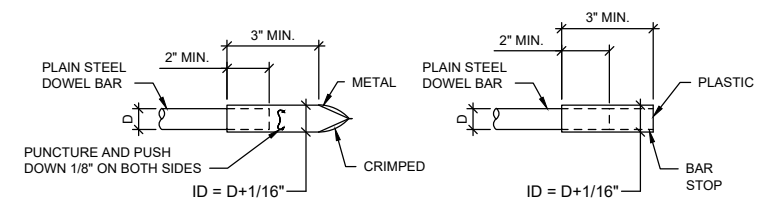

METAL OR PLASTIC CAPS FOR DOWEL BARS

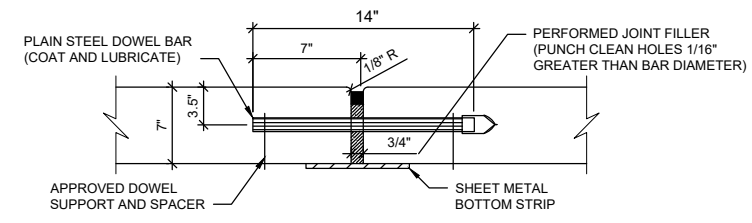

TRANSVERSE EXPANSION JOINT

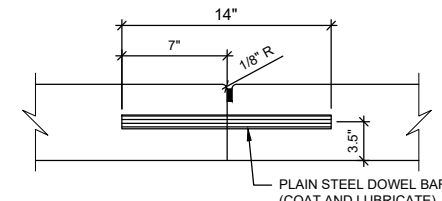

BUTT CONSTRUCTION JOINT TO BE USED AT DISCONTINUANCES OF WORK

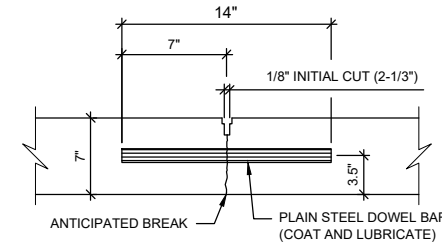

CONCRETE JOINT DETAIL
DETAIL D
50C06



REV. NO.	DATE	DRWN	REMARKS
1	6/8/20	NC	ADDENDUM NO. 2

ONE INCH AT FULL SIZE IF NOT ONE INCH SCALE ACCORDINGLY

SAN ANTONIO WATER SYSTEM
LEON CREEK WRC
ELECTRICAL SYSTEM IMPROVEMENTS PHASE I
CIVIL
PLUMBING CIVIL DETAILS

DESIGNED BY: C. SMITH
DRAWN BY: N. CANDELAS
SHEET CHKD BY: P. KRISHNA
APPROVED BY: P. KRISHNA
DATE: APRIL 2020
SAWS JOB NO.: 19-6505
FILE NAME: 50C06

SHEET NO.
50C06
7 OF 77

6/3/2020 12:16 PM I:\ACAD\PROJ\02186057_SAWS\2-SHEET\504-C-Civil\50C06.dwg Candelas, Nick

6/3/2020 12:50 PM Z:\1951_SAWS_Dos Rios WRC Electrical System Improvements - Phase II(5 Drawings)\Leon Creek\Electrical\Working\1951_60E02.dwg Emmanuel Rangel

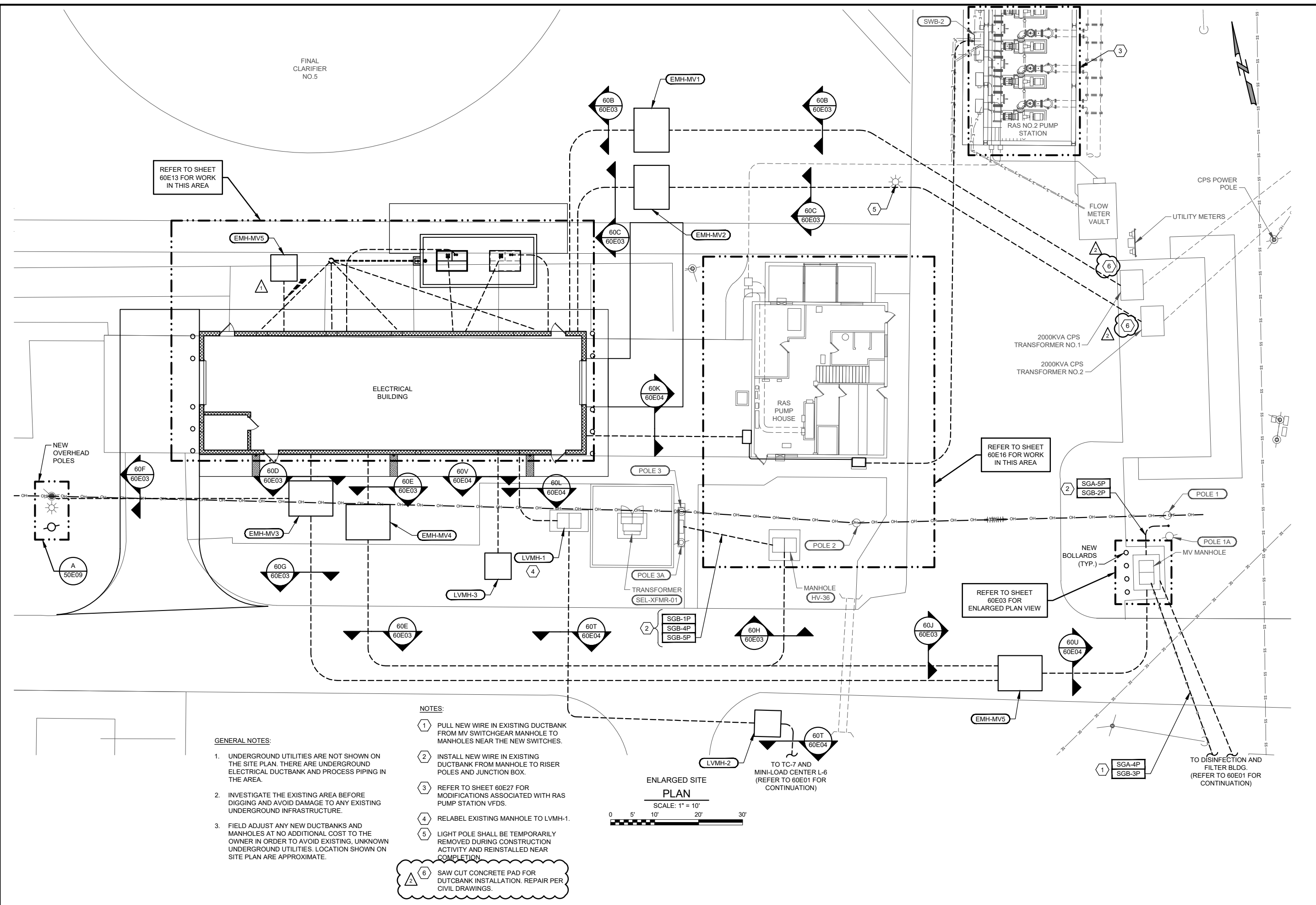

- GENERAL NOTES:**
- UNDERGROUND UTILITIES ARE NOT SHOWN ON THE SITE PLAN. THERE ARE UNDERGROUND ELECTRICAL DUCTBANK AND PROCESS PIPING IN THE AREA.
 - INVESTIGATE THE EXISTING AREA BEFORE DIGGING AND AVOID DAMAGE TO ANY EXISTING UNDERGROUND INFRASTRUCTURE.
 - FIELD ADJUST ANY NEW DUCTBANKS AND MANHOLES AT NO ADDITIONAL COST TO THE OWNER IN ORDER TO AVOID EXISTING, UNKNOWN UNDERGROUND UTILITIES. LOCATION SHOWN ON SITE PLAN ARE APPROXIMATE.

- NOTES:**
- PULL NEW WIRE IN EXISTING DUCTBANK FROM MV SWITCHGEAR MANHOLE TO MANHOLES NEAR THE NEW SWITCHES.
 - INSTALL NEW WIRE IN EXISTING DUCTBANK FROM MANHOLE TO RISER POLES AND JUNCTION BOX.
 - REFER TO SHEET 60E27 FOR MODIFICATIONS ASSOCIATED WITH RAS PUMP STATION VFDS.
 - RELABEL EXISTING MANHOLE TO LVMH-1.
 - LIGHT POLE SHALL BE TEMPORARILY REMOVED DURING CONSTRUCTION ACTIVITY AND REINSTALLED NEAR COMPLETION.

6 SAW CUT CONCRETE PAD FOR DUCTBANK INSTALLATION. REPAIR PER CIVIL DRAWINGS.

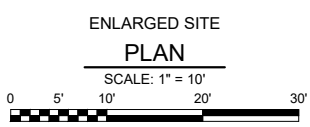

GAI
Gupta & Associates, Inc.
CONSULTING ENGINEERING
Registration No. F-2893
13777 Nestor Road
Dallas, Texas 75244
Tel: 972-405-1225
email: gai@gaiairng.com

04/13/20

SAN ANTONIO WATER SYSTEM

REMARKS

ONE INCH AT FULL SIZE IF NOT ONE INCH SCALE ACCORDINGLY

REV. NO.	DATE	DRWN	REMARKS
1	05/18/20	ER	ADDENDUM NO.1
2	06/08/20	ER	ADDENDUM NO.2

SAN ANTONIO WATER SYSTEM
LEON CREEK WRC
ELECTRICAL SYSTEM IMPROVEMENTS PHASE I

ENLARGED SITE PLAN

DESIGNED BY: D.GHOBRIAL

DRAWN BY: E.RANGEL

SHEET CHKD BY: V.K. GUPTA

APPROVED BY: W.SAKO

DATE: APRIL 2020

SAWS JOB NO.: 19-6505

FILE NAME: 1951_60E02

SHEET NO.

60E02

51 OF 77

100% SUBMITTAL - ISSUED FOR BID